

Mapping Notes

• Existing contours shown were generated from GRID information obtained from the West Virginia GIS Technical Center.

Call Two Working Days Before You Dig!
WEST VIRGINIA 811
 CALL BEFORE YOU DIG! Dial 811 or 800.245.4848
 www.WV811.com

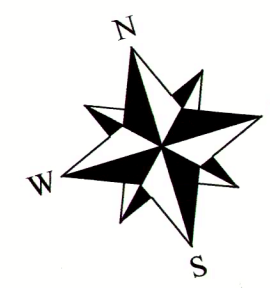

Legend

- Property Boundary
- Property to be Acquired
- Right-of-Way
- Existing Grade Contour (Index)
- Existing Grade Contour (Intermediate)
- Existing Stream
- Proposed Earthwork Limits
- Proposed Grade Contour (Index)
- Proposed Grade Contour (Intermediate)
- Proposed Grade Spot Elevation
- Proposed Collection Channel

PRELIMINARY
 NOT FOR CONSTRUCTION

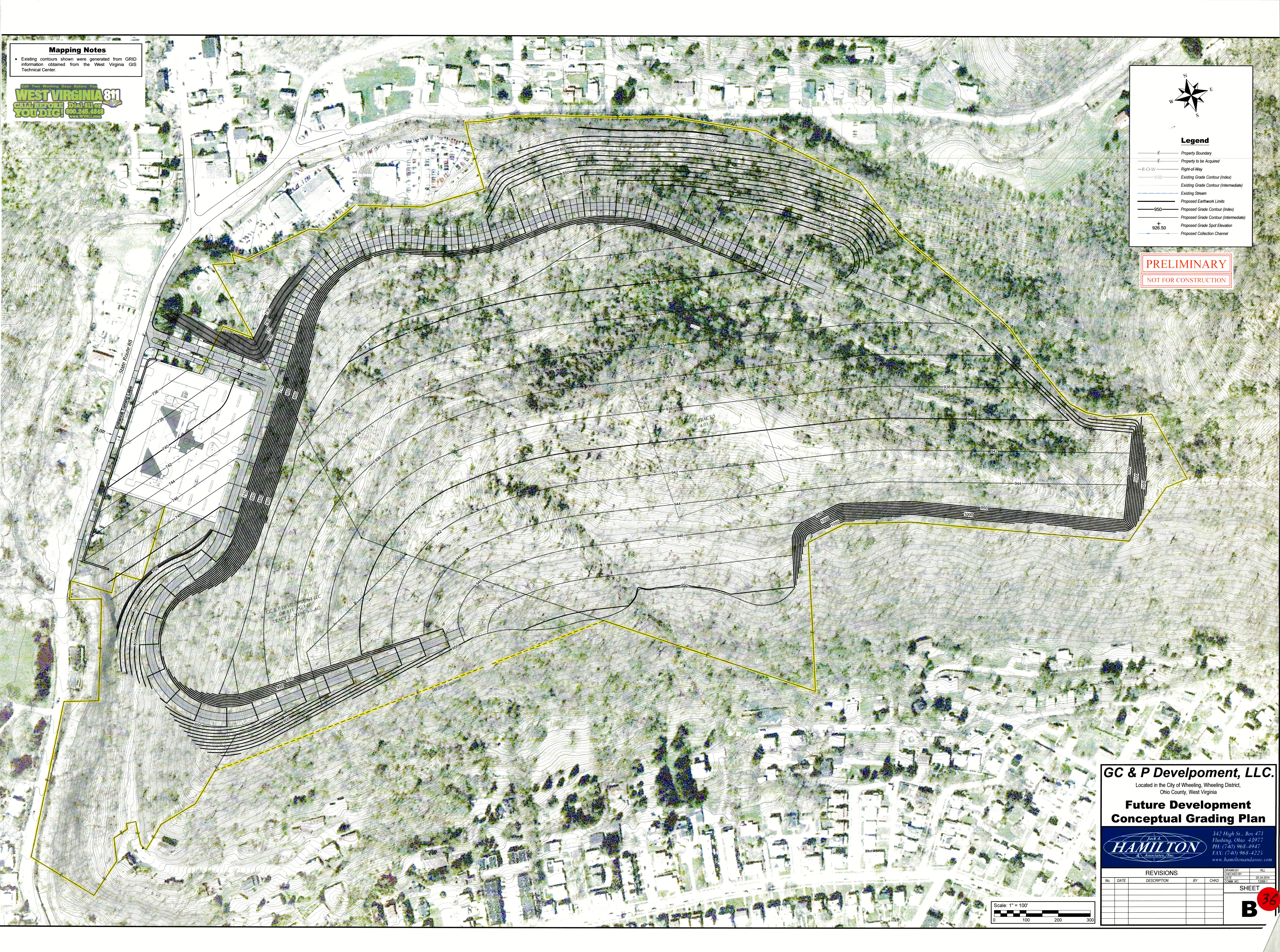

GC & P Development, LLC.
 Located in the City of Wheeling, Wheeling District,
 Ohio County, West Virginia

**Future Development
 Conceptual Grading Plan**

Jack A.
HAMILTON
 & Associates, Inc.
 342 High St., Box 471
 Flushing, Ohio 43977
 PH: (740) 968-4947
 FAX: (740) 968-4225
 www.hamiltonandassoc.com

REVISIONS					DATE	BY	CHKD	APPD
No.	DATE	DESCRIPTION	BY	CHKD				

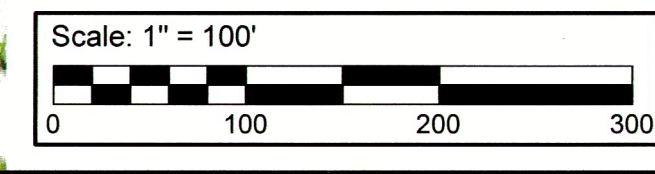

SHEET
B 36